

Paediatric Urine Collection

Preparation

Ensure the child's genital area is thoroughly washed and dried and is free from powder.

Collecting the specimen

1. Wash your hands and remove the protective strip from the urine (wee) bag to expose the adhesive (sticky side). **Do not put your fingers inside the bag as you will contaminate the sample.**

Female Collection

The bag must be placed between vagina and the anus. To apply the bag: place the wider part of the bag opening above the vagina, and the narrower part between the vagina and anus. Press firmly so the bag sticks to the skin, to avoid urine leaking. To catch the urine: position the bag downwards as urine is likely to flow in this direction.

Male Collection

The bag must be placed under the scrotum (balls) To apply the bag: Place the wider part of the bag opening under the scrotum, insert the penis into the bag. Press firmly so the bag sticks to the skin, to avoid urine leaking. To catch the urine: position the bag upwards as urine is likely to flow in this direction.

2. Give the child a drink to encourage urination. If you put a nappy on them, make sure it is not tight.

Check every 15 minutes to see if urine has passed. **Do not leave the bag on for more than one hour.** Take the bag off if the child's skin gets irritated or the child shows allergy symptoms.

3. When urine appears in the bag, gently remove it. Fold the two adhesive sides together and seal the bag.

4. Hold the bag over the specimen pot. Empty content of the bag into the specimen pot by peeling away the blue tab at the bottom of the urine bag. Place the empty urine bag in the bin.

5. Close the specimen pot by screwing the lid on tightly. Write the time the specimen was collected on the specimen pot.

6. Place the specimen pot into the collection bag provided and wash your hands.

Equipment



1 x specimen pot.



1 x collection bag



1 x child urine bag

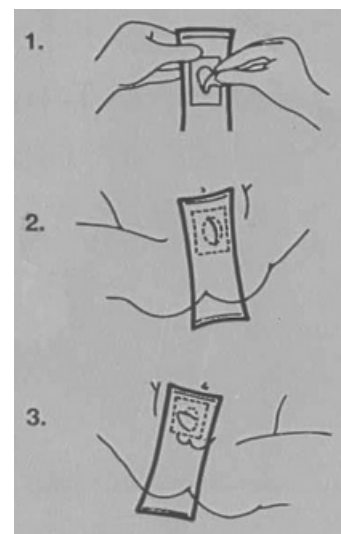

Labelling the specimen

Label the specimen by writing:

- Write your child's full name (first & last name)
- Date of birth
- Record Number (if known)
- Date & time you collected each specimen.

Delivering the specimen

Deliver the specimen to a pathology collection centre as soon as possible.

Keep the specimen in the fridge if you are unable to deliver it within two hours of collection.

See next page for full list of collection centres